

UNIQUE

XTRA TUFF VICES



SINCE 1971

PRECISION VICES

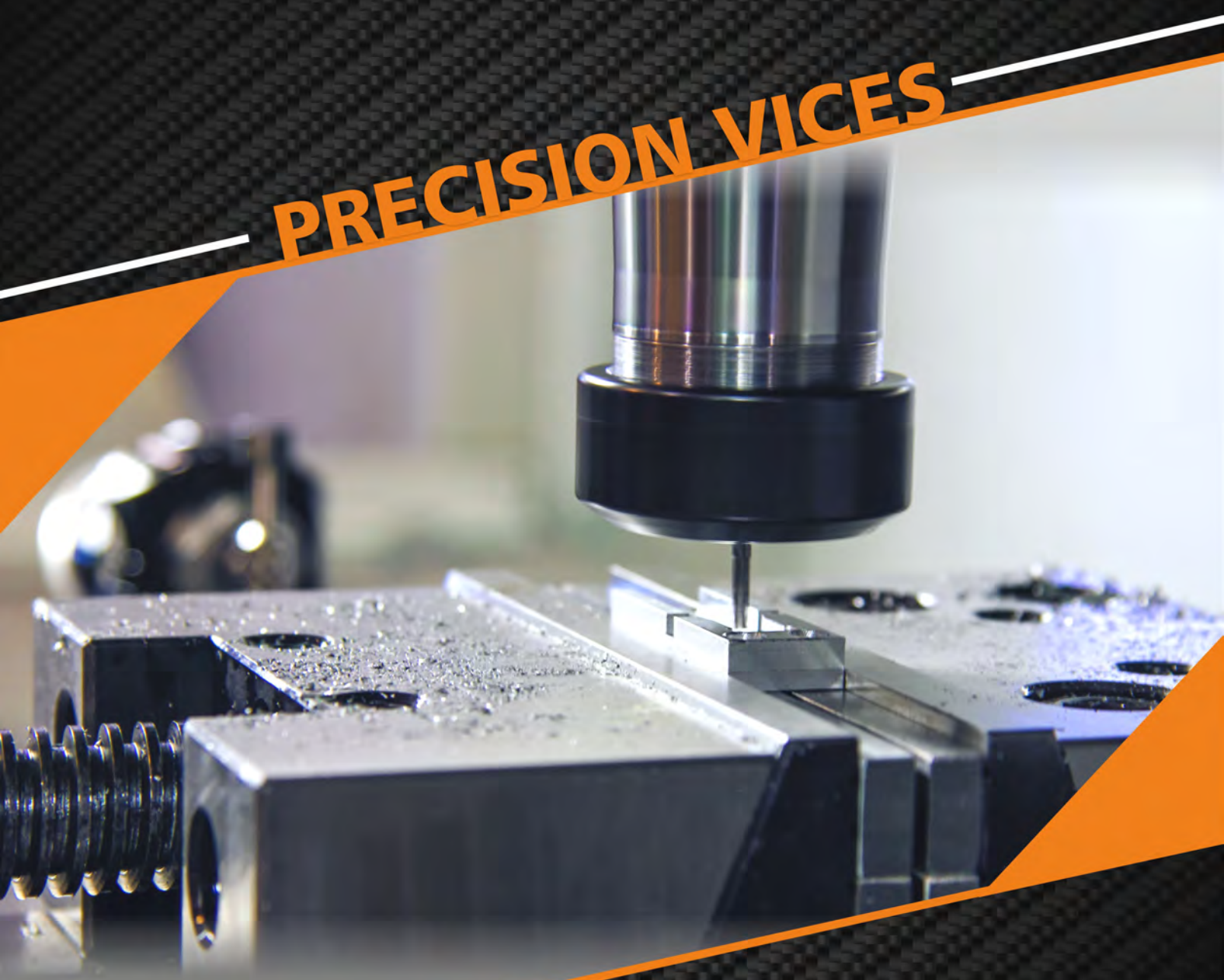

www.uniquevices.com

UNIQUE PROCESS MAKES THE **UNIQUE** VICES PRECISION AND STURDY

UNIQUE MODULAR PRECISION MACHINE VICE WITH TAPER JAWS

HARDENESS : 60 ±2 HRC

Code No. U3333

FEATURES

- HIGH QUALITY ALLOY STEEL
- ACCURACY IN SQUARENESS ± 0.01/100 MM
- CASE HARDENED HRC 60 ±2 TO GIVE MAXIMUM RIGIDITY, HIGH PERFORMANCE & NO WEAR.
- CAN BE USED MULTIPLE STYLE
- BOTH JAWS PLATES ARE IN PULL-DOWN ANGLE. THIS ENSURES ANTI-LIFT CLAMPING OF THE WORKPIECE.
- LOW PROFILE
- SUPPLIED WITH STOPPER FOR FAST PRODUCTION

SIZE IN INCHES	Opening 225mm		Opening 300mm		Opening 300mm		Opening 400mm	
	4	5	6	6	8	8	8	8
A Width of jaws in mm	100	125	150	150	200	200	200	200
B Opening of jaws in mm	130	175	225	300	300	400	400	400
C Depth of jaws in mm	40	40	50	50	60	60	60	60
D Length overall in mm	325	375	450	525	555	655	655	655
E Height overall in mm	70	90	98	98	118	118	118	118
F Width Overall	102	125	150	150	203	203	203	203
Tenon slot Size in mm	16	16	16	16	16	16	16	16
Weight (Approx) in kgs	9	17	27	30	48	54	54	54

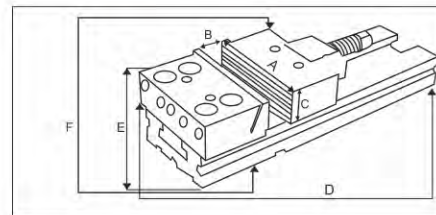
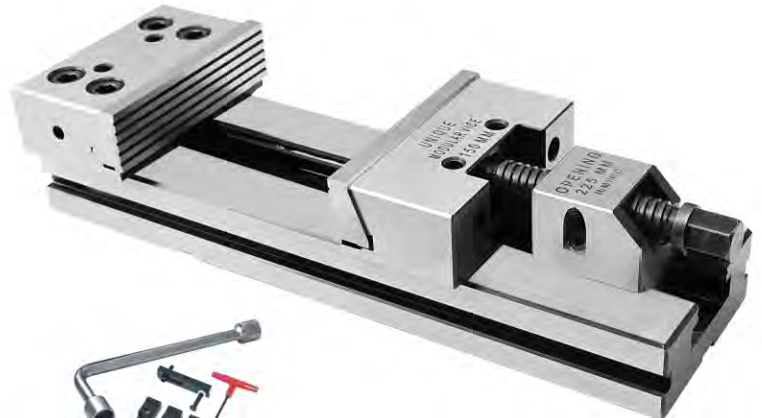

Code No. U3333 PJ

UNIQUE MODULAR PRECISION MACHINE VICE (WITH PARALLEL TOP JAWS) HARDENESS : 60 ±2 HRC

FEATURES

- HIGH QUALITY ALLOY STEEL
- ACCURACY IN SQUARENESS ± 0.01/100 MM
- CASE HARDENED HRC 60 ±2 TO GIVE MAXIMUM RIGIDITY, HIGH PERFORMANCE & NO WEAR.
- CAN BE USED MULTIPLE STYLE
- BOTH JAWS PLATES ARE IN PULL-DOWN ANGLE. THIS ENSURES ANTI-LIFT CLAMPING OF THE WORKPIECE.
- LOW PROFILE
- SUPPLIED WITH STOPPER FOR FAST PRODUCTION

SIZE IN INCHES	Opening 225mm		Opening 300mm		Opening 300mm		Opening 400mm	
	4	5	6	6	8	8	8	8
A Width of jaws in mm	100	125	150	150	200	200	200	200
B Opening of jaws in mm	130	175	225	300	300	400	400	400
C Depth of jaws in mm	40	40	50	50	60	60	60	60
D Length overall in mm	325	375	450	525	555	655	655	655
E Height overall in mm	71	90	98	98	118	118	118	118
F Width Overall	102	125	150	150	203	203	203	203
Tenon slot Size in mm	16	16	16	16	16	16	16	16
Weight (Approx) in kgs	9	17	27	30	48	54	54	54

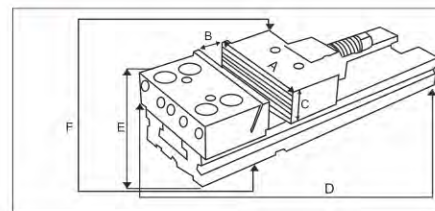
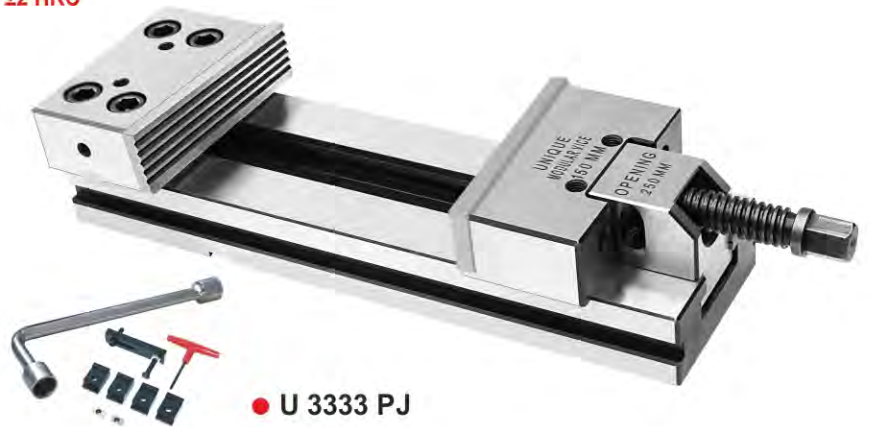

UNIQUE TWO PIECE MODULAR PRECISION MACHINE VICE WITH TAPER JAWS

HARDNESS : 60 ±2 HRC

Code No. U3434

FEATURES

- High alloyed quality resistance steel, case hardened HRC 60 ±2 is used in all body and accessories of vice to give maximum rigidity, high performance & no wear.
- Two Piece Modular Vice designed for precision milling used with CNC Machines.
- Accuracy in squareness 0.01/100 MM.
- Unlimited Clamping Range as per Workpiece.
- Both jaws plates are in pull-down angle. This ensures Anti-Lift Clamping of the Workpiece.
- Ideal for Machining Centre to hold the Long Work Pieces.

SPECIFICATIONS

	SIZE IN INCHES	6	8
A	Width of jaws in mm	150	200
B	Opening of jaws in mm	As per Job	As per Job
C	Depth of jaws in mm	50	60
D	Length overall in mm	Assorted	Assorted
E	Height overall in mm	100	118
F	Width Overall	150	200
	Tenon slot Size in mm	16	16
	Weight (Approx) in kgs	26	48

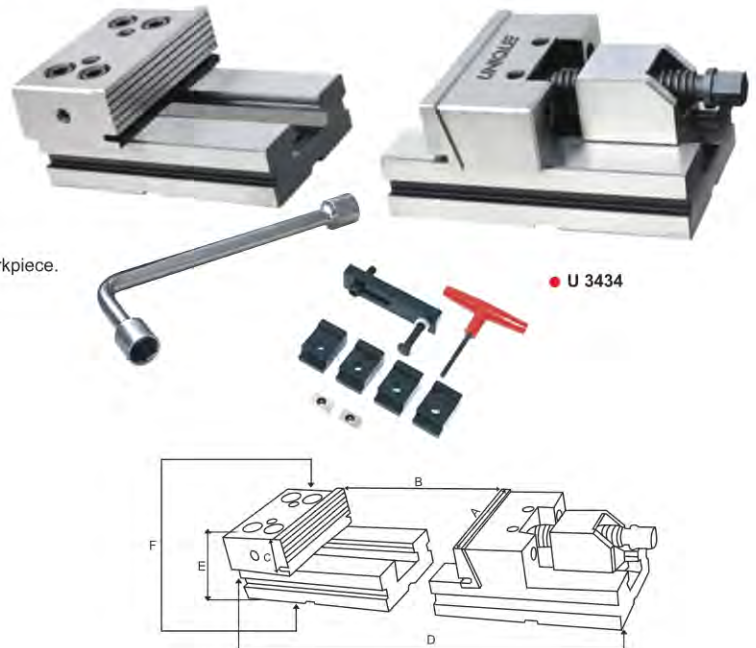

UNIQUE PRECISION SELF CENTERING 5 AXIS VISE

**COMPATIBLE FOR :
4TH & 5TH AXIS CNC MACHINING CENTRES
CODE NO. U3131**

FEATURES

- Self Centering 5-Axis Machine Vice for Precision 4 & 5 Axis CNC, both in Horizontal or Vertical Machining.
- It is Precision Vice Centre Repetition Position ± 0.02 MM.
- High Alloyed Quality Steel, Case Hardened HRC 60 ± 2.
- All components of Vice are interchangeable with Perfect Alignment to provide different Work Holding Solutions.
- Minimum Clamping Depth of workpiece 3 or 4 mm gives enormous Material Savings.
- Highest Clamping Power at Minimum Clamping Size.
- Accuracy in squareness ± 0.02/100 mm

	SIZE IN INCHES	2	3	4	6
A	Width of jaws in mm	50	75	100	150
B	Standard Jaw Opening in mm	45	60	75	125
C	Standard Jaw Opening (Diamond Teeth)	50	65	80	130
D	Reverse Jaw Opening in mm	75	100	125	175
E	Reverse Jaw Opening (Diamond Teeth)	80	105	130	180
F	Depth of jaws in mm	25	25	30	30
G	Height Overall in mm	70	73	90	90
H	Length overall in mm	120	160	180	230
I	Tenon slot size in mm	12	12	16	16
J	Weight (Approx) in kgs.	2.500	3.500	9	14
K	Clamping Hole Distance in mm	55	55	85	100
L	Zero Clamping Hole Distance (X) in mm	52	52	52	96
M	Zero Clamping Hole Distance (Y) in mm	52	52	52	96

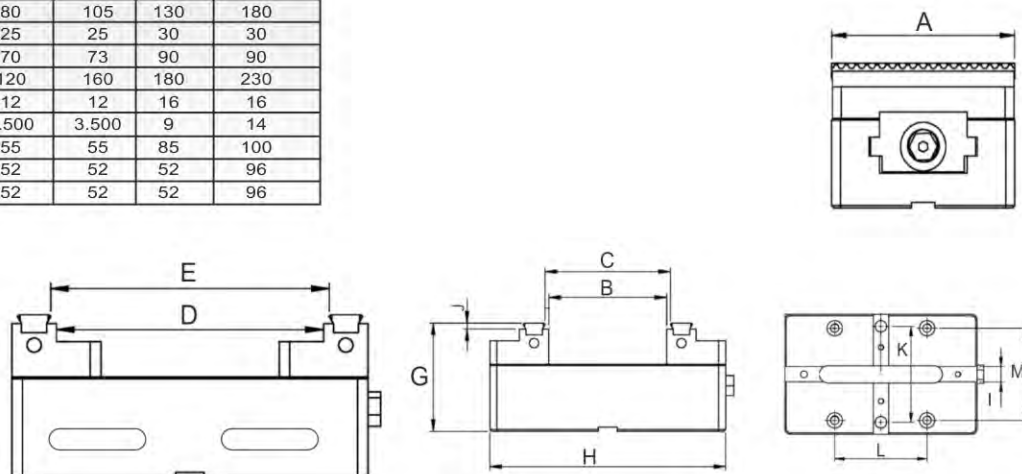

Code No. U3131 - RB
UNIQUE RISER BLOCK

FEATURES

- High Quality Aluminium
- Accuracy in Squareness $\pm 0.01/100$ Mm

SPECIFICATIONS

SIZE IN MM	50	75	100	150
A1 Mounting Holes In X	125	125	125	125
A2 Mounting Holes In X	-	160	200	250
B Mounting Holes In Y	95	95	125	175
C Tenon Slot	12	12	16	16
D1 Length Of Block	105	140	175	225
D2 Length Of Block	115	220	225	275
E Block Height	100	100	100	100
F1 Width Of Block	75	75	100	150
F2 Width Of Block	115	115	150	200
G Vice Mounting Hole M12	55	55	80	125
H1 Zero Clamping Hole Distance in X	52	52	52	96
H2 Zero Clamping Hole Distance in Y	52	52	52	96

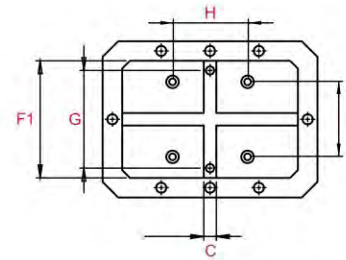
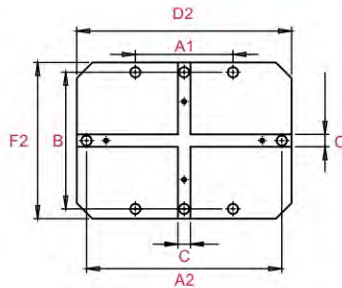
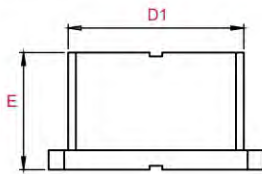

CODE NO. U 2424
UNIQUE PRECISION MULTI GRIP VICE
 SERRATED SLIDE WAYS
 (ALSO AVAILABLE WITHOUT SERRATIONS)

FEATURES

- UNIQUE Precision Multi Grip Machine Vices are compact, rigid & specially designed for clamping multiple work pieces of various sizes.
- Use of Multi Grip Vice maximise the machine table capacity and helps to increase the productivity.
- The system is compact & reliable for holding multiple work pieces at the same time thereby reducing tool changeover times.
- Precise accuracy in positioning and alignment ± 0.02 mm.
- Vice Body & Accessories are of High Quality Alloy Steel, Case Hardened HRC 60 ± 2 for maximum rigidity, high performance & longer life without wear.
- Supplied with 3 fixed jaws & two wedge clamps.

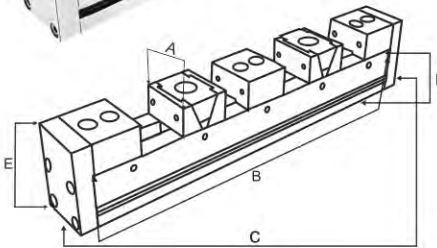
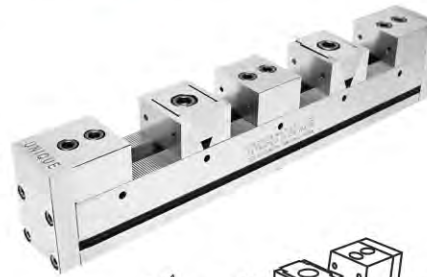

SPECIFICATIONS

A Width in mm	70
Holding Capacity in mm	60 - 4 Pcs
Holding Capacity in mm	180 - 2 Pcs
Holding Capacity in mm	225 - 2 Pcs
B Bed Working Area	540
C Length overall in mm	580
D Bed Height in mm	70
E Height overall in mm	110
Tenon slot Size in mm	12
Weight (Approx) in kgs	22

CODE NO. U 2626
UNIQUE WEDGE CLAMP

FEATURES

- UNIQUE Wedge Clamps are ideal for multiple clamping operations as well clamping individual work pieces.
- Wedge Clamp Clamping provides consistent accurate clamping force through socket head cap screw by moving both jaws outward.
- Hidden Springs eliminate clogging of chips.
- Hardened & Ground Wedge surfaces with Hi-Tensile socket head cap screw.
- Serrated Jaw faces are also available.

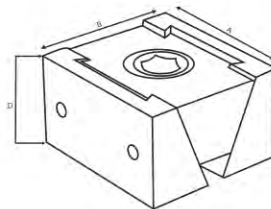

SPECIFICATIONS

Width of jaws in mm	50	60	70
T - Nut	12	14	16

CODE NO. U 2121
UNIQUE PRECISION HIGH GRIP MACHINE VICE

FEATURES

- UNIQUE Precision High Grip Machine Vices are compact, rigid & specially designed for Precision Milling, Grinding & CNC Operations.
- Unbreakable High Strength Ductile Iron Body.
- Grounded Top & Bottom.
- High Quality Alloy Steel, Case Hardened HRC 60 ± 2 clamping jaws for high performance & longer life without wear.
- Tenon & tenon slots provided for effortless truing of vice on machine table.
- Accuracy in parallelism & squareness within 0.02 / 100 mm.
- Interchangeable Jaw Plates available.
- Smooth & effortless handle movement to achieve high clamping force. (Max : 5000 Kg.)

SPECIFICATIONS

	SIZE IN INCHES	6
A	Width of jaws in mm	150
B	Opening of jaws in mm	250
C	Length overall in mm	360
D	Bed Height in mm	70
E	Height overall in mm	113
	Tenon slot Size in mm	20
	Weight (Approx) in kgs	22

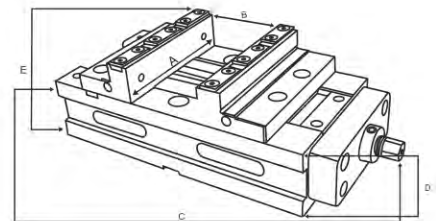

SPECIFICATIONS

	SIZE IN INCHES	6
A	Width of jaws in mm	150
B	Opening of jaws in mm	380
C	Length overall in mm	530
D	Bed Height in mm	90
E	Height overall in mm	130
	Tenon slot Size in mm	20
	Weight (Approx) in kgs	38

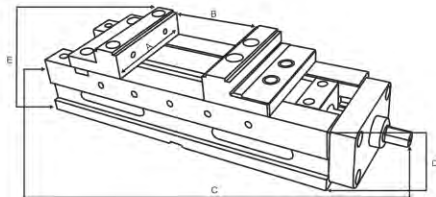

CODE NO. U 2727
UNIQUE PRECISION WIRE EDM VICE
STAINLESS STEEL - 420

FEATURES

- 45 Degree angle clamping provides excellent holding force on work piece
- Precision wire cutting vise is used wire edm machine
- Parallelism within 0.005/100mm
- Squareness within 0.005/100mm
- Hardness 50-55 degree HRC
- Can be accurated clamping and suitable for small parts

APPLICATION

- Mold and die manufacturing process
- These processes include milling, turning, small hole drilling and more.



SPECIFICATIONS

	Jaw Width	150 mm
A	Opening in mm	150
B	Depth of jaws in mm	50
C	Width in mm	22
D	Length overall in mm	270
E	Height overall in mm	150
F	Weight (Approx) in kgs	6 Kg.

CODE NO. U 2222
UNIQUE PRECISION SELF CENTERING HIGH GRIP MACHINE VICE

FEATURES

- UNIQUE Precision Self Centering High Grip Machine Vices are compact, rigid & specially designed for Precision Milling, Grinding & CNC Operations.
- Compact Design with large opening suitable for 4th & 5th Axis Rotary Tables.
- Vice is suitable for holding two work pieces with optional intermediate jaw.
- Unbreakable High Strength Ductile Iron Body.
- Grounded Top & Bottom.
- High Quality Alloy Steel, Case Hardened HRC 60 ± 2 clamping jaws for high performance & longer life without wear.
- Tenon & tenon slots provided for effortless truing on vice of machine table.
- Accuracy in parallelism & squareness within 0.02 / 100 mm.
- Interchangeable Jaw Plates available.
- Smooth & effortless handle movement to achieve high clamping force. (Max : 3000 Kg.)

SPECIFICATIONS

	SIZE IN INCHES	6
A	Width of jaws in mm	150
B	Opening of jaws in mm	250
C	Length overall in mm	320
D	Bed Height in mm	70
E	Height overall in mm	113
	Tenon slot Size in mm	20
	Weight (Approx) in kgs	20

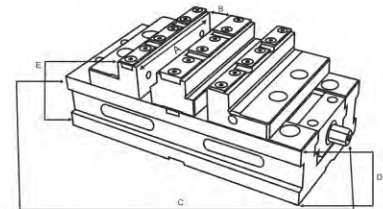

SPECIFICATIONS

	SIZE IN INCHES	6
A	Width of jaws in mm	150
B	Opening of jaws in mm	380
C	Length overall in mm	500
D	Bed Height in mm	90
E	Height overall in mm	130
	Tenon slot Size in mm	20
	Weight (Approx) in kgs	40

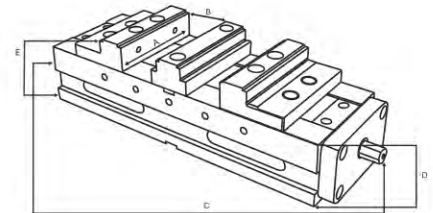

CODE NO. U 2525
UNIQUE PRECISION HI GRIP SELF CENTERING SHAFT VICE VEE BLOCK TYPE

FEATURES

- UNIQUE Precision High Grip Self Centering Shaft Vices are compact, rigid & specially designed for Accurate Centring of Round Jobs on Precision Milling Machines & CNC Operations.
- Unbreakable High Strength Ductile Iron Body.
- Grounded Top & Bottom.
- Perfectly designed vice for rigid gripping & mass production.
- High Quality Alloy Steel, Case Hardened HRC 60 ± 2 clamping jaws for high performance & longer life without wear.
- Tenon & tenon slots provided for effortless truing on vice of machine table.
- Smooth & effortless handle movement to achieve high clamping force without hammering.

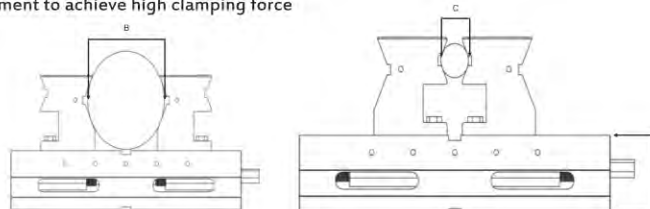
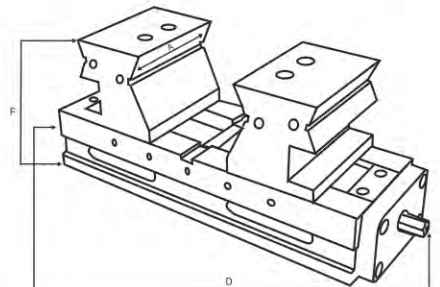

SPECIFICATIONS

	SIZE IN INCHES	6	6
A	Width of jaws in mm	150	150
B	Holding Capacity Standard Jaws in mm	40-100	50-150
C	Holding Capacity Reverse Jaws in mm	20-40	30-50
D	Length overall in mm	320	500
E	Bed Height in mm	70	90
F	Height overall in mm	150	205
	Tenon slot Size in mm	20	20
	Weight (Approx) in kgs	28	56

UNIQUE TILT LOCK MACHINE VICE

KURT TYPE

SWIVEL BASE CODE NO. U350S

FIXED BASE CODE NO. U350

FEATURES

- Rigid Material Vice Body of Ductile Iron.
- Flame Hardened Bed.
- Fitted with Thrust Bearing for Smooth Movement
- Unique Tilt Lock Vices can with stand heavy jobs.
- Top & Bottom of vice bed, bottom & both sides of jaws & all jaw mounting surfaces are precision ground.
- By reversing the jaw plates the jaws are raised & can be fitted to both ends of the fixed jaws & the moveable jaws.
- The four different positions of jaw plates pair are available for more gripping area.
- Coolant through on vise body and swivel base.
- Chip clearance holes no dead pockets.
- Swivel handle allows the screw head revolved on machine table.
- The vice can be disassembled and repaired by regrounding.
- Supplied with Stopper for Fast Production
- Accuracy in squareness $\pm 0.02/100$ mm

SPECIFICATIONS

SIZE IN INCHES	Opening						
	200MM	250MM	300MM	400MM			
A Width of jaws in mm	100	125	150	150	200	200	300
B Opening of jaws in mm	100	120	150	200	250	300	400
C Depth of jaws in mm	40	40	45	45	60	60	70
D Width Swivel Base in mm	225	270	310	310	410	410	-
E Width Fixed Base in mm	175	205	220	220	310	310	375
F Height Swivel Base in mm	140	145	170	170	220	220	-
G Height Fixed Base in mm	100	100	125	125	160	160	165
H Length overall in mm	345	375	460	460	595	595	775
Tenon slot size in mm	16	16	20	20	20	20	20
Weight (Approx) in kgs, Swivel Base	21	29	48	48	94	98	-
Weight (Approx) in kgs, Fixed Base	16	21	35	35	64	68	120
2 Opening	150	170	215	265	300	350	450
3 Opening	230	250	310	360	400	450	600
4 Opening	270	295	370	420	490	540	690



U 350

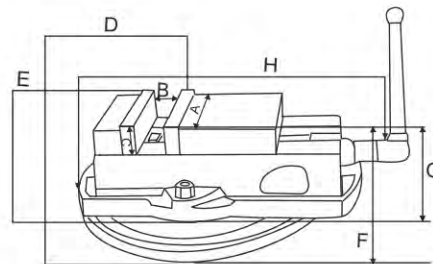

UNIQUE PRECISION COMPACT LOCK MACHINE VICE

CODE NO. U 350 P

FEATURES

- This vice can be clamped vertical or either side.
- High clamping force can be achieve by effortless handle movement which eliminates hammering on handle.
- Hardened jaws maintain accuracy for long time.
- Enhanced body Structure reduces the deflection in operation while the vice mounted vertical or horizontal.
- Ductile iron body.
- Sealed bearing system reduces clamping pressure and increases bearing life.
- Accuracy in parallelism & squareness with in 0.02/100mm
- No work piece tilt after clamping.
- All parts are interchangeable
- Tenon and tenon slots provided for effortless truing of vice.
- SUPPLIED WITH STOPPER FOR FAST PRODUCTION

SPECIFICATIONS

SIZE IN INCHES	6
Width of jaws in mm	150
Max. Opening with standard jaw position	200
Max. jaw opening with jaw reversed	430
Depth of jaws in mm	45
Overall length in mm	515
Overall height in mm	125
Nett weight in kgs	35
Tenon slot size in mm	20



U 350 P

UNIQUE ANGLE LOCK SELF CENTERING VICE CODE NO. U 350 SCV

FEATURES

- This vice can be clamped vertical or either side.
- High clamping force can be achieved by effortless handle movement which eliminates hammering on handle.
- Hardened jaws maintain accuracy for long time.
- Enhanced body Structure reduces the deflection in operation while the vice mounted vertical or horizontal.
- Ductile iron body.
- Sealed bearing system reduces clamping pressure and increases bearing life.
- Accuracy in parallelism & squareness with in 0.02/100mm
- No work piece tilt after clamping.
- All parts are interchangeable
- Tenon and tenon slots provided for effortless truing of vice.
- **SUPPLIED WITH STOPPER FOR FAST PRODUCTION**

SPECIFICATIONS

SIZE IN INCHES		6
Width of jaws in mm		150
Max. Opening with standard jaw position		200
Max. jaw opening with jaw reversed		430
Depth of jaws in mm		45
Overall length in mm		490
Overall height in mm		125
Nett weight in kgs		36
Tenon slot size in mm		20



U 350 SCV

UNIQUE PRECISION DUAL STATION VICE (HARDENED GROUND GUIDE WAYS) DUCTILE CAST IRON BODY Code No. U355

FEATURES

- Rigid Material Vice Body of Ductile Iron.
- Clamping force equalization same force to two workpieces in different size.
- Anti-lift mechanism ensure the workpiece does not lift during operation
- Double clamp makes different size of workpieces can be clamped at the same time.
- Can be mounted Horizontally or Vertically.
- One Handle operate the two Moveable Jaws.
- Fixed Center Jaw has a Machined Keyway for Accurate Alignment and Setup.
- 5 Different Workpiece Clamping Applications.
- Accuracy in Squareness within 0.02/100MM.

SPECIFICATIONS

Size in Inches		6
A	Width of jaws in mm	152
B	Opening of jaws each side in mm	0-125
B1	Maximum Opening in mm	0-310
C	Depth of jaws in mm	45
D	Length overall in mm	520
E	Height overall U 3535	127
F	Width Overall U 3535	150
G	Tenon slot Size in mm	20
	Weight (Approx) in kgs U 3535	50 Kg.



U-355

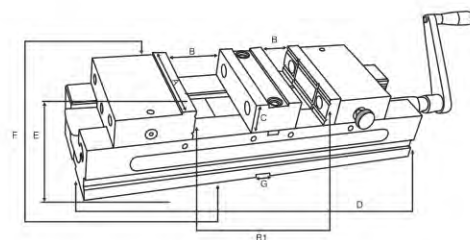
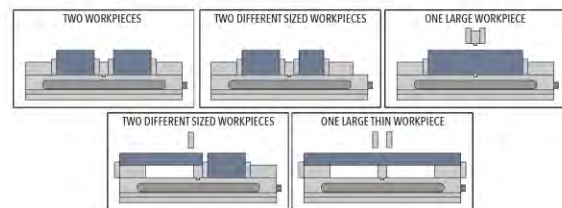

UNIQUE HYDRAULIC PRESSURE VICE (HARDENED GROUND GUIDE WAYS)

Code No. U-3510

FEATURES

- Rigid Material Vice Body of Ductile Iron for milling, drilling, shaping, grinding and many other machine shop applications.
- New Design: Lock Proof System : Prevent wrong clamping force sticks the vise.
- Clamping Force : 4000-4500 KGF.
- Sliding Bed ways hardened and ground.
- Concealed spindle for protection against chips and dirt.
- Hydraulic - Booster system for maximum clamping pressure with minimum force.
- Quick of clamping & locking and easy of operation.
- Accuracy in Squareness within 0.02/100MM.
- Furnished with or without swivel base.



● U 3510



SPECIFICATIONS

	100MM	Opening 300MM	Opening 200MM
SIZE IN INCHES	4	6	6
A Width of jaws in mm	105	150	150
B Opening of jaws in mm	175	300	200
C Depth of jaws in mm	36	58	58
D Length overall in mm	440	620	510
E Height overall U 3510	95	145	145
F Width Overall U 3510	170	230	230
G Tenon slot Size in mm	20	20	20
Height overall U 3510 S	125	185	185
Width Overall U 3510 S	200	300	300
Weight (Approx) in kgs U 3510	19	53	48
Weight (Approx) in kgs U 3510 S	22	65	60

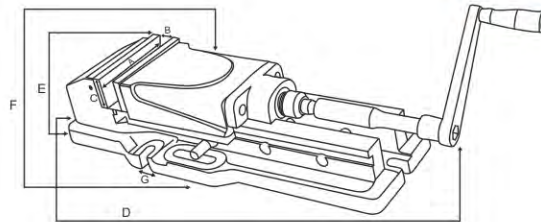

UNIQUE PRECISION TILT LOCK HYDRAULIC VICE (HARDENED GROUND GUIDE WAYS)

Code No. U-5510

FEATURES

- Rigid Material Vice Body of Ductile Iron.
- Clamping Force : 4000-4500 KGF.
- Sliding Bed ways hardened and ground.
- Hydraulic - Booster system for maximum clamping pressure with minimum force.
- Downthrust Semi - Sphere segment mechanism eliminates Jaw Lifting and Work Lift.
- Quick of clamping & locking and easy of operation.
- Accuracy in Squareness within 0.02/100MM.



● U 5510

SPECIFICATIONS

	Opening 200MM	Opening 300MM
SIZE IN INCHES	6	6
A Width of jaws in mm	160	160
B Opening of jaws in mm	200	300
C Depth of jaws in mm	58	58
D Length overall in mm	520	710
E Height overall U 5510	165	165
F Width Overall U 5510	160	160
Tenon slot Size in mm	20	20
Weight (Approx) in kgs U 5510	50	60

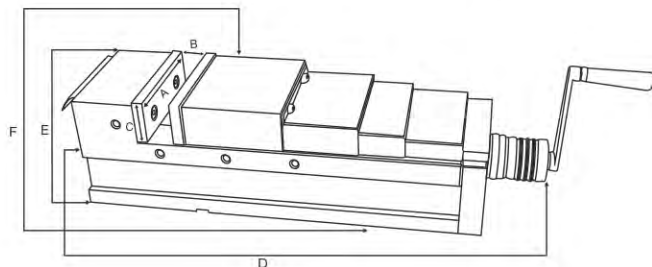

Code No. U2828

UNIQUE QUICK CLAMPING HYDRAULIC VICE

FEATURES

- Rigid Material Vice Body for milling, drill, shaping, grinding and many other machine shop applications.
- Clamping Force : 4000-4500 KGF.
- Very Easy and Quick to Clamp and Declamp Job
- Sliding Bed ways hardened and ground.
- maximum clamping pressure with minium force.
- Accuracy in Squareness within 0.02/100MM
- In Built Hydraulic Pump
- Zero Maintenance
- Very Easy and Quick to Clamp and Declamp Job

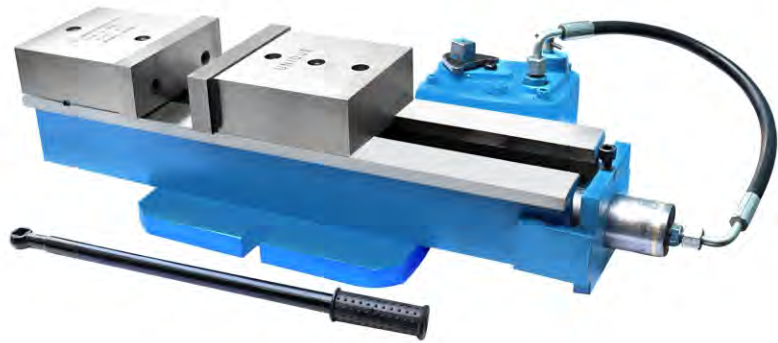

150MM

SIZE IN INCHES	6
Width of jaws in mm	150
Opening of jaws in mm	300
Depth of jaws in mm	58
Length overall in mm	620
Height overall	145
Width Overall	230
Tenon slot Size in mm	20
Weight (Approx) in kgs U 2828	53

UNIQUE MILLING MACHINE VICE

SWIVEL BASE CODE NO. U310S

FIXED BASE CODE NO. U310

Code No.U 310 S

FEATURES

- Fitted with Thrust Bearing for Smooth Movement
- Sturdy & accurately made machine vices from graded casting.
- Fine acme thread screw.
- Jaws are made of special steel properly hardened, fixed jaw is provided with vertical & horizontal 'V' groove to hold the round job firmly.
- The swivel base is graduated fully through 360°.
- Vice can be converted from swivel base to fix by removing the base.
- Quick alignment to machines through longitudinal slot provided in base & body.
- Crank handle is made of unbreakable steel provided with a spring loaded mechanism providing positive grip.
- Supplied with Stopper for Fast Production

ALSO AVAILABLE IN DUCTILE IRON (UNBREAKABLE BODY)



U 310 S

U 310

STOPPER

SPECIFICATIONS

	SIZE IN INCHES	2	3	4	5	6	8	10	12
A	Width of jaws in mm	50	75	100	125	150	200	250	300
B	Opening of jaws in mm	50	75	100	125	150	200	250	300
C	Depth of jaws in mm	25	35	40	50	50	60	75	75
D	Length overall in mm	210	280	340	410	470	610	770	830
E	Height overall U310S in mm	80	100	125	140	150	165	190	190
F	Height overall U310 in mm	55	70	90	105	110	120	140	140
G	Width overall U310S in mm	97	144	168	206	250	318	372	452
H	Width overall U310 in mm	85	128	157	195	240	300	350	416
	Tenon slot Size in mm	16	16	16	20	20	20	-	-
	Weight (Approx) U310S in kgs	3.5	9	16	27	40	73	132	175
	Weight (Approx) U310 in kgs.	2	6	12	21	30	55	105	140

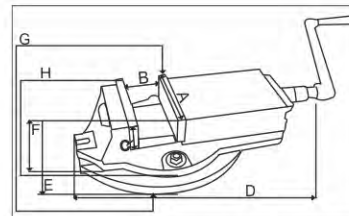

UNIQUE ROTARY MILLING TABLES

FEATURES

- The Table & Body manufactured from close grain shock resisting cast iron.
- The body is provided with two bolt slots in Code No. U335 & U337 for mounting on machine
- Table vertically & Horizontally.
- Provided with quick & precise disengagement of worm drive.
- Efficient lock provided.
- End play in wormshaft is adjustable.
- An eccentric sleeve with thrust Bearing races in the worm shaft. Provision for fine zero adjustment when setting work piece. Works as an index centre in the vertical position as well as conventional Rotary Table graduated 360° Indexing Plate is provided
- to enable the user to convert quickly to use indexing plates for fast setting.
- Direct reading to 2 minutes for size 6", 8" & 10" on hand wheel scale.
- Direct reading to 1 minute for size 12", 15", 18" & 20" in hand wheel scale.
- High accuracy, easy reading of all dials clear & functional arrangement of all operating elements sturdy yet simple good looking practical design. These are widely used for circular cutting, angle setting, boring & spot facing with a milling machine.

SPECIFICATIONS

SIZE IN INCHES	4	6	8	10	12	15	18	20
Dia. of Table in mm	100	150	200	250	300	375	450	500
Table slot in mm	8	9	12	12	16	16	20	20
Centre Bush Bore	MT No.-1	MT No.-2	MT No.-3	MT No.-3	MT No.-3	MT No.-3	MT No.-4	MT No.-4
Worm & Gear Ratio	1.72	1.72	1.72	1.72	1.120	1.120	1.120	1.120
Calibration	2 Min	2 Min	2 Min	2 Min	1 Min	1 Min	1 Min	1 Min
Overall Height in mm								
Vertical U335 & U337	153	250	290	360	430	540	620	670
Horizontal U334 & U336	-	100	100	110	135	135	170	172
Base to centre U335- U337	84	130	155	175	215	270	305	335
No. of indexing Holes	-	19, 27, 30, 33, 41, 47	-	-	19, 27, 30, 33, 41, 47, 53, 61	-	-	-
	-	23, 25, 28, 31, 39, 43	-	-	23, 25, 28, 31, 39, 43, 51, 59,	-	-	-
Approx. weight in kgs.								
Code No. U334	-	17	26	38	68	100	195	212
Code No. U336	-	19	28	40	71	104	197	210
Code No. U335	5	18	27	40	73	111	210	230
Code No. U337	5.6	20	29	42	76	114	212	232
Width Overall U334,336	155	255	290	375	420	545	600	600
Width Overall U335,337	64	100	104	110	135	140	170	170



ACCURACY :-

- Maximum error 2 minutes of circular division using hand wheels.
- Table flat to within 0.005mm/100mm.
- Working surface rotates in its own plane to within 0.01 mm.
- Horizontal & vertical supporting surface square within 0.01mm/100mm.
- Centre bush bore is true to table axis within 0.008 mm.
- Maximum parallelism error through 360° rotation of table is 0.001mm.

CODE NO. U 353 UNIQUE PRECISION ROTARY MILLING TABLE HORIZONTAL & VERTICAL



FEATURES

- The Table & Body manufactured from close grain shock resisting cast iron.
- The body is provided with two bolt slots for mounting on machine.
- Table vertically & Horizontally.
- Provided with quick & precise disengagement of worm drive.
- Efficient lock provided.
- End play in wormshaft is adjustable.
- An eccentric sleeve with thrust Bearing races in the worm shaft. Provision for fine zero adjustment when setting work piece. Works as an index centre in the vertical position as well as conventional Rotary Table graduated 360° Indexing Plate is provided
- to enable the user to convert quickly to use indexing plates for fast setting.
- Direct reading to 2 minutes on hand wheel scale.
- High accuracy, easy reading of all dials clear & functional arrangement of all operating elements sturdy yet simple good looking practical design. These are widely used for circular cutting, angle setting, boring & spot facing with a milling machine.
- Rotary Table can be Tilted to 90° in Code U 354.

CODE NO. U 354 UNIQUE PRECISION TILTING ROTARY MILLING TABLE



SPECIFICATIONS

SIZE IN INCHES	6	8
Dia. of Table in mm	150	200
Table slot in mm	10	13
Centre Bush Bore	MT No.-2	MT No.-3
Worm & Gear Ratio	1.90	1.90
Calibration	2 Min	2 Min
Overall Height in mm		
Vertical U353	210	265
Horizontal U354	130	180
Base to centre U353, U354	100	135
Approx. weight in kgs.		
Code No. U353	12	25
Code No. U354	19	45
Width Overall U353	370	27
Width Overall U354	330	400

UNIQUE HEAVY DUTY PRECISION MACHINE VICE (HARDENED GROUND GUIDE WAYS)

Code No. U-3210

FEATURES

- Rigid Material Vise Body of Ductile Iron.
- Both jaws plates are in pull-down angle. This ensures Anti-Lift Clamping of the Workpiece.
- Trouble Free Performance.
- Accuracy in squareness within 0.02/100 MM
- Jaw Plates are made out of Tool Steel (45-50 HRC).



● U 3210 S



● U 3210

SPECIFICATIONS

	SIZE IN INCHES	6
A	Width of jaws in mm	165
B	Opening of jaws in mm	150
C	Depth of jaws in mm	56
D	Length overall in mm	550
E	Height overall U 3210	135
	Height overall U 3210 S	175
F	Width Overall U 3210	230
	Width Overall U 3210 S	270
	Tenon slot Size in mm	20
	Weight (Approx) in kgs U 3210	43
	Weight (Approx) in kgs U 3210 S	54

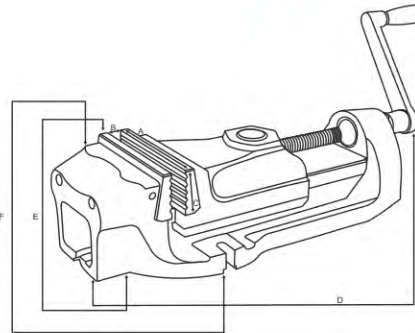

UNIQUE SUPER MILLING VICE

Bridge Port Type

SWIVEL BASE CODE NO. U309S

FIXED BASE CODE NO. U309

Code No.U309 S

FEATURES

- Fitted with Thrust Bearing for Smooth Movement
- Sturdy & accurately made machine vices from graded casting.
- Fine acme thread screw.
- Jaws are made of special steel properly hardened, fixed jaw is provided with vertical & horizontal 'V' groove to hold the round job firmly.
- The swivel base is graduated fully through 360°.
- Vice can be converted from swivel base to fix by removing the base.
- Quick alignment to machines through longitudinal slot provided in base & body.
- Crank handle is made of unbreakable steel provided with a spring loaded mechanism providing positive grip.
- Body is provided with water channel.
- Depth of jaws is more to hold heavy jobs.
- Supplied with Stopper for Fast Production



U309 S

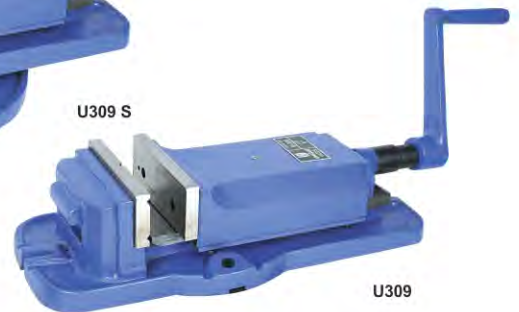

U309

SPECIFICATIONS

	SIZE IN INCHES	4	5	6	8
A	Width of jaws in mm	100	125	150	200
B	Opening of jaws in mm	100	125	150	200
C	Depth of jaws in mm	45	50	55	65
D	Length overall in mm	344	400	470	610
E	Height overall U309S in mm	120	130	140	160
F	Height overall U309 in mm	90	100	110	120
G	Width overall U309S in mm	208	250	270	310
H	Width overall U309 in mm	165	192	220	275
	Tenon Slot Size in mm	16	20	20	20
	Weight (Approx) U309S in kgs.	17	30	38	66
	Weight (Approx) U309 in kgs.	13	20	29	52

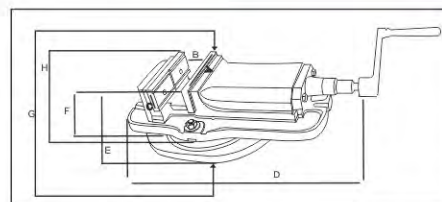

UNIQUE TILTING & SWIVELLING VICE

Code No. U312

FEATURES

- Fitted with Thrust Bearing for Smooth Movement
- Positive locking to withstand heavy loads.
- Horizontal Swivel movement 360°.
- Vertical swivel movement 90°.
- Fine acme thread screw made out of special steel.
- Quick alignment to machine tables using a longitudinal slot.
- One vertical Two horizontal 'V' grooves are provided in hardened and ground jaws
- Crank Handle is made of unbreakable steel provided with a spring loaded mechanism.
- Supplied with Stopper for Fast Production

ALSO AVAILABLE IN DUCTILE IRON (UNBREAKABLE BODY)

SPECIFICATIONS

	SIZE IN INCHES	2	3	4	5	6	8
A	Width of jaws in mm	50	80	100	125	150	200
B	Opening of jaws in mm	50	75	100	125	150	200
C	Depth of jaws in mm	25	38	42	50	50	60
D	Length overall in mm	210	285	370	450	540	640
E	Height overall in mm	95	225	160	170	195	220
G	Width overall in mm	105	140	170	228	236	280
	Tenon Slot Size in mm	16	16	16	20	20	20
	Weight (Approx) in kgs.	4	8.5	18	30	44	73



UNIQUE 3 WAY UNIVERSAL TILT & SWIVEL ANGLE VICE

CODE NO. U330.

FEATURES

- Fitted with Thrust Bearing for Smooth Movement
- Body is made of grey cast iron.
- High quality ACME steel screw.
- Hardened & accurately ground jaws provided with 'V' groove
- This vice can't set up at any angle with positive locking.
- Upper angle base can incline from the horizontal position to the vertical position.
- The lower angle setting base can incline up to 45° in both right & left directions.
- The entire unit may be swivelled on a base plate through 360°
- Quick alignment to machines through longitudinal slot provided in base.
- Crank handle is made of unbreakable steel provided with a spring loaded mechanism providing positive grip.
- Supplied with Stopper for Fast Production

SPECIFICATIONS

	SIZE IN INCHES	2	3	4	6
A	Width of jaws in mm	50	75	100	150
B	Opening of jaws in mm	50	75	100	150
C	Depth of jaws in mm	24	34	42	55
D	Overall Height in mm	110	167	220	290
E	Width Overall	105	140	235	280
F	Overall Length in mm	210	275	420	570
	Base Tenon Slot in mm	12	12	20	20
	Weight (Approx) in kgs.	4	11	34	62



UNIQUE UNIVERSAL MACHINE VICE CODE NO. U313

FEATURES

- Accurately designed for use on surface, universal tool & cutter grinding machines.
- Unbreakable steel body.
- Accurately ground jaws made out of special steel for firm grip.
- All swivelling movements have positive locking and the job can be locked at any compound angle.



U313

SPECIFICATIONS

SIZE IN INCHES		2	3	4	6
A	Width of jaws in mm	50	75	100	150
B	Opening of jaws in mm	50	75	65	115
C	Depth of jaws in mm	25	35	32	40
D	Height overall in mm	140	190	175	225
E	Width Overall	104	145	135	220
F	Length Overall	168	240	345	395
	Tenon Slot size in mm	12	12	16	16
	Weight (Approx) in kgs.	4.3	12	12	25

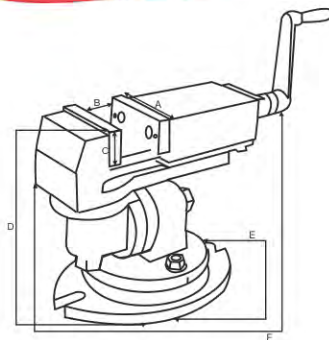

UNIQUE SHAPER VICE SWIVEL BASE CODE NO. U311S FIXED BASE CODE NO. U311

FEATURES

- Heavy duty shaper vice sturdy constructed from close grain casting for use on shaper machines, planners & other heavy duty machines permitting wider application for taller work pieces.
- It is designed to permit maximum opening jaws to hold heavy & taller jobs.
- High tensile steel square thread screw.
- The jaws are made of special steels. These are precisely ground & serrated to ensure firm grips on heavy jobs..
- Swivel base is indexed to 360°, when required to use as stationary vice, the base can be removed.
- Crank Handle is made of unbreakable steel, provided with a spring loaded mechanism providing positive grip.



U311S



U311

SPECIFICATIONS

SIZE IN INCHES		6	8	10	12	16
A	Width of jaws in mm	150	200	250	300	400
B	Opening of jaws in mm	200	250	300	360	400
C	Depth of jaws in mm	50	60	75	75	75
D	Length overall U311S in mm	530	700	770	860	910
E	Length overall U311 in mm	475	635	710	800	850
F	Width overall U311S in mm	220	290	320	380	480
G	Width overall U311 in mm	200	280	320	360	460
H	Height overall U311S in mm	155	170	200	200	225
I	Height overall U311 in mm	120	130	160	165	190
	Weight (Approx) U311S in kgs	32	64	105	145	200
	Weight (Approx) U311 in kgs.	25	47	79	102	145

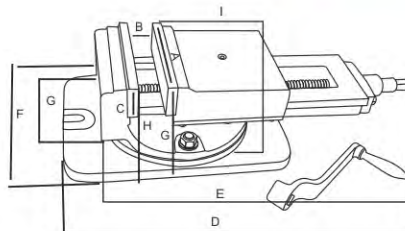

CODE NO. U 352
**UNIQUE UNIVERSAL
 DIVIDING HEAD**
 (Fitted with 200 mm Self Centering Chuck)



CHUCK SIZE 200 mm

SIZE IN MM	200
A	359
B	340
H	235
l	20
a	212
b	135
g	16
h	134
Taper of Center	MT-4
Spindle Through Hole	25

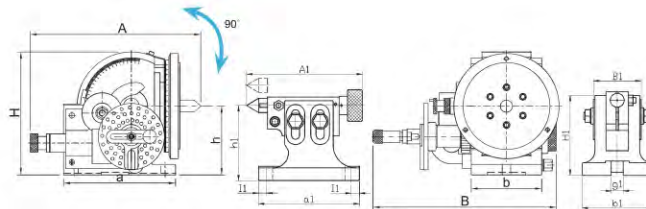

UNIQUE DIVIDING HEAD
 CODE NO. U351

FEATURES

- Unique Dividing heads are carefully designed for tool Rooms as well as for production purpose
- They are suitable for indirect and differential indexing as well as for spiral and cam milling operations on universal milling machine.
- Unique dividing heads are manufactured from Selected high quality material with Superior workmanship.

SPECIFICATIONS

SIZE IN INCHES	4.1/2	5.1/2	6.1/2	7-1/2
Gear worm ratio	1:40	1:40	1:40	1:40
Centre height in mm	115 mm	142 mm	165 mm	190mm
Spindle Bore in mm	20 mm	32 mm	38 mm	50mm
Spindle Taper	9°	9°	9°	9°
Overall height Vertical position in mm	180	230	260	290
Length of base in mm	180	230	260	270
Width of base in mm	115	150	170	180
Weight in kgs.	40	65	92	98

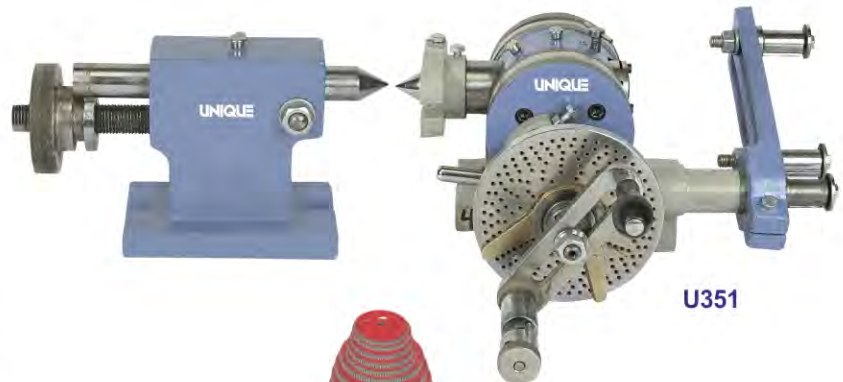

INDEXING PLATES

	4.1/2", 5-1/2"	6.1/2", 7-1/2"
SIDE A	11,16,19,25,37,41,49	7,13,16,19,20,23,27,31,33,39,47,53
SIDE B	13,17,18,27,33,43,51	9,11,15,17,18,21,25,29,37,41,49,51
SET OF GEARS	24,24,28,32,36,40,44 48,56,64,72,86,100 teeth D.P 14	24,24,28,32,36,40,44 48,56,64,72,86,100 teeth D.P 12

Indexing Milling Fixture Horizontal & Vertical (With Chuck & Tail Stock) CODE NO. U-1335

Description

Entire range of horizontal, vertical indexrd milling operations can be done with our range of products
Job Clamping is fast, indexing is quick thereby increasing production efficiency
Indexing Fixture models covers the advantage of conventional Dividing Head and Rotary Table put together.

Movable Parts are hardened & Ground for long life
Indexing accuracy is precise and products can be used on surface grinding also.

Combination of ball bearings and taper roller bearings on jig bored holes for accurate & easy rotation
Tail Stock with lead screw movement is provided for center support of long shaft / jobs
Tail Stock Center is sliding in hardened and accurately ground bushes
In most models, 24 indexing positions are provided.
There is also a graduated collar with 1 deg least count which facilitates odd degree indexing also.
With all these additional advantages, fixtures are priced much lower than conventional dividing head or rotary table.



U1335

UNIQUE TILTING INDEXING DEVICE Code No. U1333



Technical Specification

Sr. No.	Model No.	Length (mm)	Width (mm)	Height (mm)	Std. Indexing Positions	Approx. Weight (kg)	Center Height	Chuck Details	Indexing Accuracy
1	IMF H/V 080	200	110	185	24	24	85	With 80 mm 3 jaws chuck	0.03 15 s
2	IMF H/V 100	200	110	185	24	25	85	With 100 mm 3 jaws chuck	0.03 15 s
3	IMF H/V 125	200	110	185	24	30	85	With 125 mm 3 jaws chuck	0.03 15 s
4	IMF H/V 160	225	140	240	24	45	120	With 160 mm 3 jaws chuck	0.03 15 s
5	IMF H/V 200	225	140	240	24	50	140	With 200 mm 3 jaws chuck	0.03 15 s

SIZE IN INCHES	4	8
Diameter Chuck (in mm)	100	200
Length (in mm)	250	300
Width (in mm)	220	280
Height (in mm)	190	170
Swivel	360°	360°
Tilting	90°	90°
Slots Distance (in mm)	170	275
Weight (Approx) in Kgs.	16	62

UNIQUE COMPOUND SLIDING TABLES WITH CALIBRATED WHEEL & SWIVELING TABLE

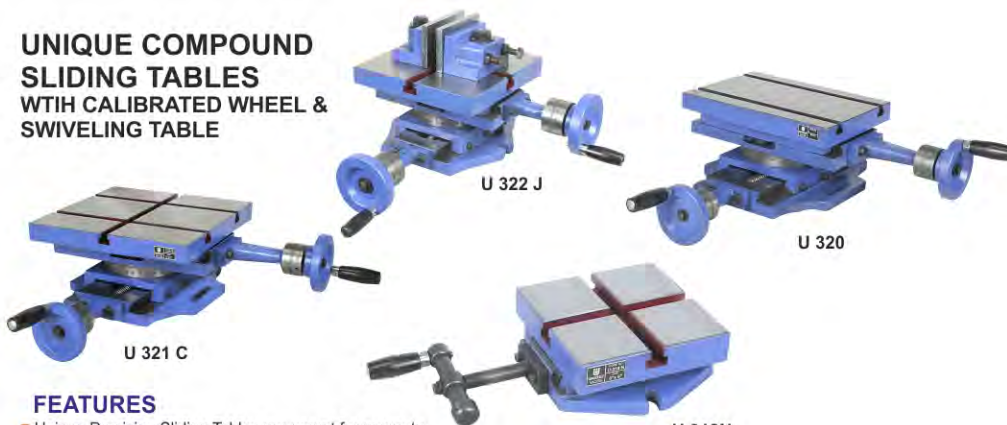

U 321 C

U 322 J

U 320

U 318 N

FEATURES

- Unique Precision Sliding Tables are meant for accurate boring, drilling grinding and milling operations.
- Grey iron casting properly machined and grinded with a Unique process provides accuracy well within 0.01mm/100mm tolerance.
- Toughened lead screw having acme threads running smoothly in phosphorus Bronze Nut.
- Dovetail slides have adjustable steel ribs for smooth running and adjustment.

SPECIFICATIONS

Code No.	U320	U321 & U321C	U322J	U322	U325N & U318N	U325N & U318N	U319	U319S	U323						
SIZE IN INCHES	12x8	12x6	12x12	12x20	16x16	8x8	4x4	6x6	8x8	10x10	8x8	6x6	12x8	12x8	12x8
Table Size in mm	300x200	300x150	300x300	300x500	400x400	200x200	100x100	150x150	200x200	250x250	200x200	150x150	300x200	300x200	200x200
Height in mm	150	150	150	165	170	190	105	120	130	130	65	60	125	145	120
Length Overall in mm	460	460	460	680	620	300	160	275	300	350	295	260	510	510	350
T. Slot Size in mm	13	13	13	16	16	13	13	13	13	13	13	13	14	14	10
Travel Bothways in mm	225	225	225	430, 310	300	125	65	105	125	125	125	105	200	200	125
Width of Jaws in mm	-	-	-	-	-	100	-	-	-	-	One way	One way	-	-	-
Depth of Jaws in mm	-	-	-	-	-	60	-	-	-	-	-	-	-	-	-
Calibration	90°	90°	90°	90°	90°	90°	90°	90°	90°	90°	-	-	-	90°	90°
Wheels graduation in inches	.002"	.002"	.002"	.001"	.001"	.001"	.001"	.001"	.001"	.001"	.001"	.001"	-	-	-
Weight Approx. in kgs	40	36	44	103	80	23	7	14	20	24	12	8	34	35	17

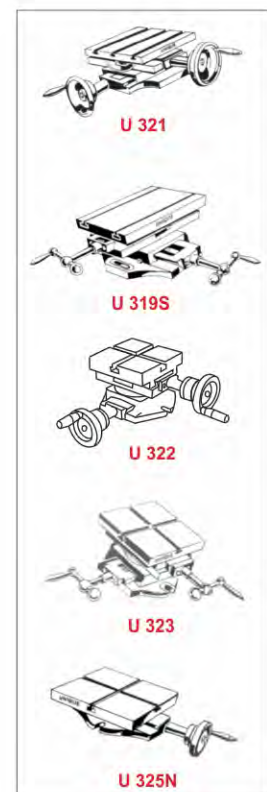

U 321

U 319S

U 322

U 323

U 325N





CODE NO. U3535
UNIQUE PRECISION QUICK SETTING MACHINE VICE



CODE NO. U 357
UNIQUE PRECISION REAR JAW TILT LOCK MACHINE VICE



CODE NO. U 348 NS
UNIQUE PRECISION MILLING MACHINE VICE



CODE NO. U 300
UNIQUE TOOL MAKER'S VICE WITH BRONZE NUT



CODE NO. U316
UNIQUE PRECISION TOOL ROOM'S BENCH VICE



CODE NO. U327
UNIQUE QUICK ACTION BENCH VICE (DOUBLE RIB)



CODE NO. U 300S
UNIQUE TOOL MAKER'S VICE WITH BRONZE NUT



CODE NO. U 316
UNIQUE PRECISION TOOL ROOM'S BENCH VICE



CODE NO. U301R STEEL
UNIQUE ENGINEER'S BENCH VICE



CODE NO. U 360
UNIQUE T-BAR CRAMPS 2" T / 2-1/2" T



CODE NO. U301
UNIQUE MECHANIC'S BENCH VICE TWIN GUIDE



CODE NO. U301S
UNIQUE MECHANIC'S BENCH VICE TWIN GUIDE (SWIVEL BASE)



CODE NO. U308
UNIQUE SUPER HEAVY DUTY BENCH VICE



CODE NO. U308S
UNIQUE SUPER HEAVY DUTY BENCH VICE (SWIVEL BASE)



CODE NO. U1301
UNIQUE MACHINIST'S BENCH VICE



CODE NO. U 319
UNIQUE VERTICAL SLIDING TABLE



CODE NO. U 338 N
UNIQUE ALL STEEL BENCH VICE



CODE NO. U 338 NS
UNIQUE ALL STEEL BENCH VICE



CODE NO. U323
UNIQUE UNIVERSAL COMPOUND VICE



CODE NO. U304
UNIQUE SELF LOCKING VICE



CODE NO. U303
UNIQUE PIPE VICE



CODE NO. U301S
UNIQUE PIPE VICE OPEN TYPE



CODE NO. U304PT
UNIQUE PIPE VICE PILLAR TYPE



CODE NO. U304 RP
UNIQUE PIPE VICE ROUND PILLAR



CODE NO. U373
UNIQUE FABRICATED STEEL PIPE VICE OPEN TYPE



CODE NO. U 372
UNIQUE HSS ADJUSTABLE
HAND REAMER



CODE NO. U374
UNIQUE CLAMP VICE
FOR HAND PUMP



CODE NO. U342
UNIQUE CHAIN PIPE VICE



CODE NO. U 421
UNIQUE PRECISION VICE
SCREW LESS



CODE NO. U 422
UNIQUE PRECISION
GRINDING VICE



CODE NO. U 424
UNIQUE PRECISION
SINE VICE PIN TYPE



CODE NO. U 425
UNIQUE PRECISION
SINE VICE LEAD SCREW TYPE



CODE NO. U 324
UNIQUE PRECISION
DRILL VICE



CODE NO. U 305
UNIQUE DRILL VICE
COMMERCIAL



CODE NO. U 3306
UNIQUE DRILL MACHINE VICE
UNBREAKABLE SG IRON



CODE NO. U 306
UNIQUE DRILL VICE
HEAVY DUTY



CODE NO. U 306 SG IRIN
UNIQUE DRILL VICE
HEAVY DUTY (SG IRON)



CODE NO. U 317
UNIQUE DRILL PRESS VICE



CODE NO. U 307 P
UNIQUE PRECISION
UNIGRIP VICE



CODE NO. U 3307P
UNIQUE 3 WAY PRECISION DRILL VICE
(WITH THREE MOUNTING OPTIONS)



CODE NO. U 3307
UNIQUE ARMATURE
BEARING PULLER VICE



CODE NO. U 315
UNIQUE SUPER DRILL
MACHINE VICE



CODE NO. U 307
UNIQUE UNIGRIP VICE



CODE NO. U 328
UNIQUE DRILL VICE
GERMAN TYPE



CODE NO. U 347
UNIQUE MECHANIC'S
BENCH VICE



CODE NO. U 343
UNIQUE SELF CENTERING
SHAFT VICE



CODE NO. U 1314 S
UNIQUE PRECISION
SELF CENTERING VICE



CODE NO. U 314
UNIQUE SELF CENTERING VICE
FIXED BASE



CODE NO. U 314 S
UNIQUE SELF CENTERING VICE
SWIVEL BASE



CODE NO. U 365
UNIQUE CAST IRON ANVIL



CODE NO. U 329
UNIQUE WOOD WORKING
VICE HEAVY DUTY



CODE NO. U 329 QR
UNIQUE WOOD WORKING
VICE QUICK RELEASE



CODE NO. U 404
UNIQUE ARBOURS FOR
DRILL CHUCKS



CODE NO. U 1333
UNIQUE TILTING
INDEXING VICE



CODE NO. U301S
UNIQUE MILLING VICE
TWO PIECE ADJUSTABLE



CODE NO. U 329
UNIQUE PRECISION
MACHINE VICE SWIVEL BASE



CODE NO. U 349 N
UNIQUE PRECISION TILTING &
SWIVELLING VICE J&S TYPE



CODE NO. U301S
UNIQUE PRECISION UNIVERSAL
TILTING TABLE



CODE NO. U 332
UNIQUE TILTING TABLE



CODE NO. U 333
UNIQUE SWIVEL
ANGLE TABLE



CODE NO. U376
UNIQUE SELF CENTERING
CORNER VICE



CODE NO. U 302
UNIQUE BABY VICE



CODE NO. U 302 N/S
UNIQUE BABY VICE



CODE NO. U 307D
UNIQUE BABY VICE WITH CLAMP
DELUXE HEAVY DUTY



CODE NO. U 340
UNIQUE HAND VICE



CODE NO. U 341
UNIQUE DRAW VICE
STEEL



CODE NO. U 406 GP
UNIQUE GEAR PULLER



CODE NO. U 406 S.P.
UNIQUE STUD PULLER
GERMAN TYPE



CODE NO. U 406
UNIQUE BEARING PULLER
FORGED STEEL UNIVERSAL



CODE NO. U 4406 D/F
UNIQUE BEARING PULLER 3 LEG
HEAVY BUSH & SPINDLE



CODE NO. U 406 DF
UNIQUE BEARING PULLER
DROP FORGED



CODE NO. U 408 DF
UNIQUE G CLAMP
DROP FORGED



CODE NO. U301R STEEL
UNIQUE G CLAMP
BAHCO TYPE



CODE NO. U 344 & 345
UNIQUE PERMANENT
MAGNETIC CHUCKS RECTANGULAR



CODE NO. U376
UNIQUE PERMANENT
MAGNETIC CHUCKS CIRCULAR



CODE NO. U 121
UNIQUE MAGNETIC
ANGLE PLATE



CODE NO. U 404 S
UNIQUE DRILL SLEEVES



CODE NO. U 119
UNIQUE STEEL V BLOCKS & CLAMPS
(EXPORT QUALITY)



CODE NO. U 117
UNIQUE MAGNETIC VEE BLOCKS



CODE NO. U 115
SINE PLATE WITH
MAGNETIC CLAMP



CODE NO. U 116
UNIQUE MAGNETIC BASE
EXPORT QUALITY



CODE NO. U 114
UNIQUE DIAL COMPRA TOR STANDS
FINE ADJUSTMENT



CODE NO. U 122
UNIQUE CAST IRON PLATES
PLAIN



CODE NO. U 123
UNIQUE CAST IRON SLOTTED
ANGLE PLATES



CODE NO. U 31
UNIQUE CLAMPING KIT
34 PCS.



CODE NO. U 32
UNIQUE CLAMPING KIT
58 PCS



CODE NO. U 09
UNIQUE UNIVERSAL STEP
BLOCK (PAIR)

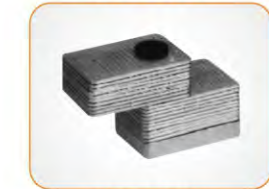

CODE NO. U 10
UNIQUE SUPPORTING HEIGHT
PLATES ADJUSTABLE



CODE NO. U 11
UNIQUE SCREW JACK
STEEL BODY



CODE NO. U 25
UNIQUE PLAIN WASHER



CODE NO. U 14
UNIQUE STRAP CLAMP

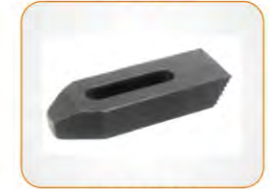

CODE NO. U 15
UNIQUE SERRATED
STRAP CLAMP



CODE NO. U 17
UNIQUE GOOSE
NECK CLAMP



CODE NO. U 26
UNIQUE SPHERICAL WASHER
WITH CONICAL SEAT



CODE NO. U 28
UNIQUE C WASHER

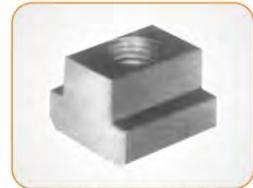

CODE NO. U 23
UNIQUE T-SLOT NUT



CODE NO. U 20
UNIQUE HEX HI NUT



CODE NO. U 21
UNIQUE FLANGE NUT



CODE NO. U 22
UNIQUE EXTENSION NUT



CODE NO. U 13
UNIQUE SELF ALIGNING PAD
RIBBED



CODE NO. U 30
UNIQUE CLAMPING STUD
IS 13178 : 1991



CODE NO. 30 S
UNIQUE CLAMPING STUD
WITH HEAVY SLOT HAVING
TAPPED HOLES



CODE NO. U 29
UNIQUE T-BOLT
IS 2014 : 1996



CODE NO. U 13 P
UNIQUE SELF ALIGNING PAD
PLAIN

UNIQUE

XTRA TUFF VICES

UNIQUE INDUSTRIES (INDIA)

Jalandhar (Punjab)



Authorized Stockist

